

GROUND FLOOR PLAN

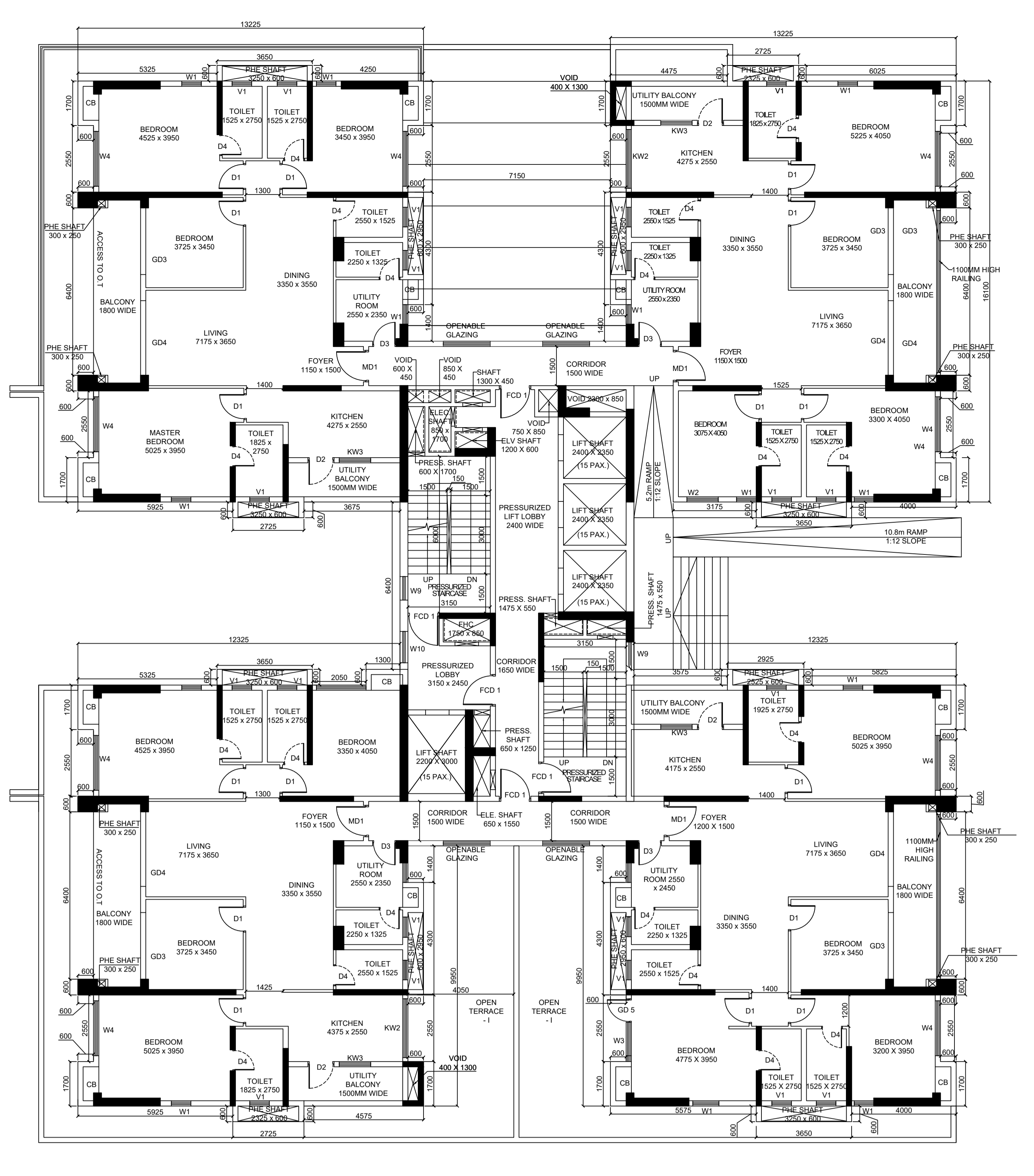

1ST FLOOR PLAN

DOOR WINDOW SCHEDULE	TAG	SIZE
FCD1	1200 X 2250	
FCD2	2000 X 2250	
FCD3	2400 X 2250	
FCD4	1000 X 2250	
MD1	1200 X 2400	
D1	1000 X 2250	
D2	1000 X 2250	
D3	900 X 2250	
D4	800 X 2250	
D5	2000 X 2250	
DK	1200 X 2250	
DD1	1800 X 2400	
DD2	1500 X 2400	
DD3	2000 X 2400	
GD1	2700 X 2400	
GD2	3000 X 2400	
GD3	2550 X 2400	
GD4	2850 X 2400	
GD4A	1000 X 2400	
GD5	900 X 2400	
FG1	2700 X 2400	
FG2	3000 X 2400	
FG3	2550 X 2400	
FG4	2850 X 2400	
FG5	2100 X 2400	
FG6	1200 X 2400	
WT	750 X 1200	
WT1	750 X 1200	
WT2	1800 X 1950	
WT3	1500 X 1950	
WT4	2100 X 1950	
WT5	2700 X 1950	
WS	2700 X 1950	

DECLARATION OF GEO TECHNICAL ENGINEER :
 UNDERSIGNED HAS INSPECTED THE SITE AND CARRIED OUT SOIL INVESTIGATION THEREON. IT IS CERTIFIED THAT THE EXISTING SOIL OF THE SITE IS ABLE TO CARRY THE LOAD COMING FROM THE PROPOSED CONSTRUCTION AND THE FOUNDATION SYSTEM PROPOSED HEREIN IS SAFE AND STABLE IN ALL RESPECT FROM GEO TECHNICAL POINT OF VIEW.

SIGNATURE OF GEO TECHNICAL ENGINEER
 JISHNU PAL
 ENROLLMENT NO. : G.T./1/32

DECLARATION OF STRUCTURAL ENGINEER :
 THE STRUCTURAL DESIGN & DRAWING OF BOTH FOUNDATION & SUPERSTRUCTURE OF THE BUILDING HAS BEEN MADE BY ME CONSIDERING ALL POSSIBLE LOADS INCLUDING SEISMIC LOAD AS PER THE NATIONAL BUILDING CODE OF INDIA & CERTIFIED THAT IT IS SAFE & STABLE IN ALL RESPECT. THE RECOMMENDATIONS OF SOIL TEST REPORT HAS BEEN CONSIDERED DURING STRUCTURAL CALCULATION.

SIGNATURE OF STRUCTURAL ENGINEER
 ANKIT AGARWALA
 ENROLLMENT NO. : ESE/1/172

DECLARATION OF STRUCTURAL REVIEWER :
 I HAVE REVIEWED/CHECKED THE STRUCTURAL DRAWING AND DESIGN DETAILS OF THIS PROJECT WHICH HAS BEEN PREPARED BY THE STRUCTURAL ENGINEER ANKIT AGARWALA, HAVING E.S.E NO. ESE/1/104 WHICH HAS BEEN DONE COMPLYING RELEVANT I.S. CODE INCLUDING SEISMIC AND NATIONAL BUILDING CODE. I CERTIFY THAT THE STRUCTURE WILL BE SAFE AND STABLE AGAINST ALL VERTICAL AND LATERAL LOADS AND WILL BE FIT FOR HABITABLE USE.

SIGNATURE OF STRUCTURAL REVIEWER
 UTPAL SANTRA
 E.S.R.NO.(STRUCTURAL REVIEWER)-ESR/(1)/58/10

CERTIFICATE OF OWNER
 I HEREBY DECLARE WITH FULL RESPONSIBILITY THAT I SHALL ENGAGE WITH THE ARCHITECT & ESE DURING CONSTRUCTION. I SHALL FOLLOW THE INSTRUCTIONS OF THE ARCHITECT & ESE DURING CONSTRUCTION. KMC AUTHORITY IS NOT LIABLE FOR STRUCTURAL STABILITY OF THE BUILDING AND ADJOINING STRUC. KMC AUTHORITY MAY REVOKE SANCTION PLAN IF ANY DOCUMENT IS FOUND FAKE.

Mr. Indranil Sen
 (AUTHORIZED SIGNATORY)
 (AMBUJA REALTY DEVELOPMENT LTD.)

CERTIFICATE OF THE ARCHITECT
 THIS IS TO CERTIFY THAT THE BUILDING PLAN HAS BEEN DRAWN AS PER THE PROVISIONS OF K.M.C BUILDING RULE 2009 AS AMENDED FROM TIME TO TIME. ABUTTING K.M.C ROAD CONFORMS WITH THE PLAN & THAT IT IS A BUILDABLE SITE.

SIGNATURE OF THE ARCHITECT
 NANDA KUMAR V.
 CA/2004/34973

PROJECT DETAILS
 PROPOSED PLAN FOR B+G+XXVII STORED RESIDENTIAL BUILDING COMPRISING OF SIX TOWERS ALONG WITH ONE NO. OF CLUB BUILDING (B+G+2) CONNECTED AT BASEMENT GROUND & PODIUM LEVEL AND A SINGLE STOREY TEMPLE BLOCK AT - PREMISES NO. 526, CHOWBAGHIA, RS. PLOT NO. / DAG NO. 651 (PART) KHATAN NO. 615 IN MOUZA NONADANGA, JL NO 10, BOROUGH NO.- XII, WARD NO 108.P.S. -ANANDAPUR P.O.-ANANDAPUR, KOLKATA 700107, COMPLYING KMC BUILDING RULE 2009 (READ WITH RULE 69A1)(a), 70(5) & 69(2)(g)) U/S 393A OF KMC ACT, 1980. ASSESSEE NO : 511080310436

PROPOSED GROUND & 1ST FLOOR PLAN

DRAWING NUMBER: UTPALAA/SANC/ G-34

SCALE: 1:100

DATE: 22.10.2024

ISSUE STATUS: SANCTION

TOWER -6

SIG. OF AE (C)BLDG./BOR.-A/18/K.M.C.

SIG. OF E.E (C)BLDG./BOR.-A/18/K.M.C.

SPACE FOR K.M.C.

BUILDING PERMIT (B.P) NO - 2024102400

DATE OF SANCTION - 15.01.2025

THE SANCTION IS VALID UP TO - 14.01.2030

